

# 1030nm Polarization Maintaining Isolator

## Product Features

The 1030 nm High Power PM Isolator is characterized with low insertion loss, high isolation, high power handling, high return loss, excellent environmental stability and reliability. It is ideal for fiber laser, and instrumentation applications.



## Specifications

Parameter	Unit	Value
Center Wavelength ( $\lambda_c$ )	nm	1030 $\pm$ 10
Max.ER	dB	20
Typ. Peak Isolation	dB	28
Min. Isolation 23 °C	dB	25
Typ. Insertion Loss, 23 °C	dB	1.0
Max. Insertion Loss, 23 °C	dB	1.2
Min. Return Loss (Input/Output)	dB	50/50
Max.Optical Power(continuous wave)	W	<3
Max. Tensile Load	N	5
Fiber Type	-	PM980
Operating Temperature	°C	0 to +50
Storage Temperature	°C	-20 to +85

## Package Dimensions

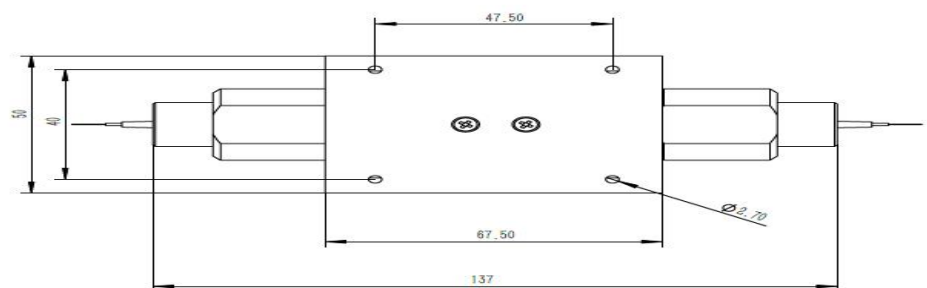
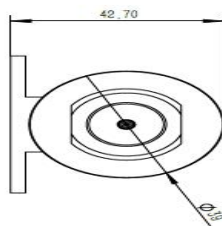

**Ordering Information**

<b>PMI</b>	<b>Wave length</b>	<b>Grade</b>	<b>stage</b>	<b>Pigtail Type</b>	<b>Fiber Length</b>	<b>Axis Alignment</b>	<b>Connector</b>
<b>1x1</b>	<b>1030nm Specify</b>	<b>P Grade A Grade</b>	<b>Single stage</b>	<b>250um bare fiber 900um loose tube Specify</b>	<b>0.5m 1m 1.5m 2m Specify</b>	<b>Fast Axis blocked Both Axis working</b>	<b>N=None FC/APC FC/UPC SC/APC SC/UPC LC/UPC Specify</b>