

1030nm Polarization Maintaining Isolator

Product Features

The 1030 nm High Power PM Isolator is characterized with low insertion loss, high isolation, high power handling, high return loss, excellent environmental stability and reliability. It is ideal for fiber laser, and instrumentation applications.



Specifications

Parameter	Unit	Value
Center Wavelength (λ_c)	nm	1030 \pm 10
Max.ER	dB	20
Typ. Peak Isolation	dB	28
Min. Isolation 23 °C	dB	25
Typ. Insertion Loss, 23 °C	dB	1.0
Max. Insertion Loss, 23 °C	dB	1.2
Min. Return Loss (Input/Output)	dB	50/50
Max.Optical Power(continuous wave)	W	<3
Max. Tensile Load	N	5
Fiber Type	-	PM980
Operating Temperature	°C	0 to +50
Storage Temperature	°C	-20 to +85

Package Dimensions

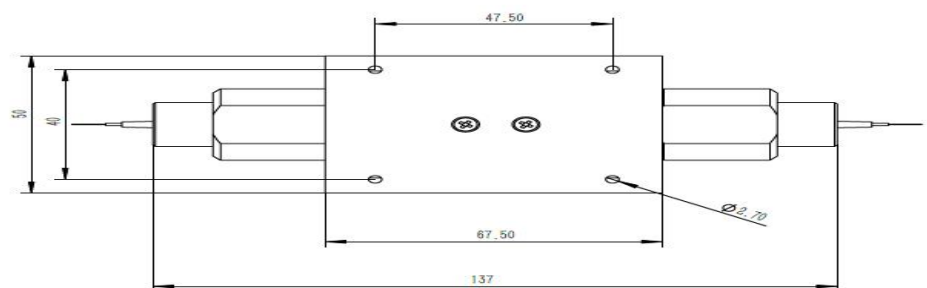
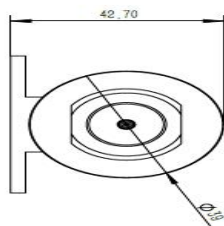

Ordering Information

PMI	Wave length	Grade	stage	Pigtail Type	Fiber Length	Axis Alignment	Connector
1x1	1030nm Specify	P Grade A Grade	Single stage	250um bare fiber 900um loose tube Specify	0.5m 1m 1.5m 2m Specify	Fast Axis blocked Both Axis working	N=None FC/APC FC/UPC SC/APC SC/UPC LC/UPC Specify